

# LEVER AND WEIGHT CHECK VALVES

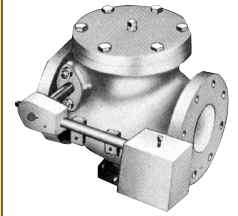

**GA FIGURE 220**

## SPECIFICATION/FUNCTION

The check valve shall be a GA Lever and Weight, rubber seated swing check valve. The valve shall permit flow in one direction only and close tightly, without slamming, when its discharge pressure exceeds its inlet pressure.

## DESCRIPTION

The swing check valve shall be installed on the discharge side of a pump with the flow direction (horizontal or vertically up), and shall function to prevent reverse flow back thru the pump when the pump is not running. The valve shall be made to operate without slam.

The hinge shaft shall be located completely above the waterway.

The valve shall be tight seating when closed, and provide a full equivalent pipe area when open fully. The seating shall be by a resilient field replaceable ring on the valve disc contacting a bronze (or stainless) seat ring in the valve body.

A Lever and Weight shall be provided to initiate valve closure.

## CONSTRUCTION

The valve body shall be of Cast Iron (ASTM A126-B) and with a Cast Iron Disc of similar material.

The hinge shaft shall be of 18-8 stainless steel with the disc arm and counterweight arm keyed thereon. The body seat shall be all Bronze (or Stainless Steel). The counterweight arm may be of the manufacturer's standard construction.

The hinge shaft packing gland shall be of the adjustable packing gland design employing a compression type packing. Simple o-ring shaft seals will not be accepted.

## FIGURE NUMBER

The valve shall be as manufactured by GA Industries of Mars, Pennsylvania; \_\_\_\_\_ inch size and shall be their Fig. 220 Lever and Weight.

## GENERAL DIMENSIONS

VALVE SIZE	STRAIGHT THRU SIZES										
	3	4	6	8	10	12	14	16	18	20	24
<b>A</b> Face to Face	12	13	17 <sup>1/2</sup>	18	23	28	33	36	40	40	48
<b>B</b> C <sub>L</sub> to Top	7	8 <sup>1/2</sup>	9	12	14	16	22	23	24	24	28
<b>C</b> C <sub>L</sub> to Bottom	5	5	6	9	9	11	13	14	18	18	20
<b>D</b> C <sub>L</sub> to Side	10	11	12	14	15	17	20	24	28	28	34
<b>E</b> C <sub>L</sub> to Side	5	5	7	8	9	11	14	16	18	18	21
<b>F</b> Ship Wt. Lbs.	100	150	230	310	480	970	1480	1860	2400	2800	6000

Multiply pounds by .4536 to obtain kilograms.  
Multiply inches by 25.40 to obtain millimeters.

## PARTS LIST

1	BODY	12	DISC ARM SET SCREWS
2	BODY SEAT	13	INNER BUSHING
2A	SEAT O-RING	14	OUTER BUSHING
2B	SEAT PINS	15	GLAND
3	DISC & CENTER PIN	16	GLAND STUDS
4	DISC ARM	17	GLAND PACKING
5A	RENEWABLE SEAT	18	SHAFT LOCK PIN
5B	SEAT FOLLOWER	19	DISC ARM KEY
5C	SEAT SCREWS	30	COUNTER WIEGHT ARM
5D	METAL SEAT WASHER	30A	CTW ARM SET SCREWS
6	DISC NUT	30B	CTW ARM KEY
6A	DISC NUT WASHER	31	COUNTERWEIGHT
6B	DISC NUT PIN	31A	CTW SET SCREW
8	COVER GASKET	33	COVER PLUG
9	COVER	34	SHAFT END PLATE
10	COVER BOLTS	35	END PLATE BOLTS
11	SHAFT	36	END PLATE SEAL

SECTION SHOWING ALTERNATE VALVE WITH METAL TO METAL SEAT. SEAT AND SEAT FOLLOWER ARE ONE PIECE. (OPTIONAL AT EXTRA COST. CONSULT FACTORY.)

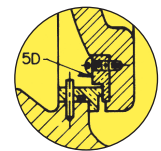

## BODY CROSS SECTION

Valves available with DIN, ISO, BS or special flanges.

